

Congratulations on the purchase of your Terra Composter

Please read through all instructions before starting.

TO START

For the installation of your Terra Composter you will need an area with solid level ground. Placing the Terra on several flat bricks would be ideal. Find a location that gets a lot of sun (sun and heat help to promote the decomposition of compost) and that is easy to access both the front and back of the composter.

See figure 1 & 2 for proper compost set up.

Ensure there is about 1-3 inches of fresh black soil in the bottom of your composter to help initiate the compost cycle.

EASY COMPOSTING

The general speculation is that composting is hard work, but it doesn't have to be. With a few simple steps to follow that can work with your every day schedule your garden will be enjoying fresh compost in no time.

Compost Recipe:

It is important to have a proper ratio of brown materials (high in carbon) and green materials (high in nitrogen). Too much brown materials and the compost will take years to decompose. Too much green and your compost will become soggy and smelly. A 3:1 brown to green ratio is ideal (three parts brown to one part green). Do fret however, compost materials eventually break down no matter what you do.

Sample:

1 part fresh grass clippings
1 part dry leaves
1 part good soil

Brown Ingredients	Green Ingredients
Corn cob stalks	Coffee grounds
Paper	Eggshells
Pine needles	Fruit and veggie peels
Sawdust or wood shavings	Grass clippings
Straw	Fresh leaves
Dry leaves	Fresh weeds

Each layer should be about 3 inches deep and repeated until composter is full.

What a composter needs:

Other than the materials placed in the composter to decompose there are two other important factors for good compost.

Oxygen: To break down the compost more efficiently microorganisms need a lot of oxygen. At first your pile will have plenty of oxygen between the layers, however, as the microorganisms work they will use up the supply. It is important to replenish the oxygen or the microorganisms will become sluggish. To do so simply find a firm twig and stick it deep into a vent hole and wiggle it around. This will create a hole in the compost allowing oxygen to enter. Do the same for the rest of the holes.

Water: Too much moisture could drown the microorganisms and too little could dehydrate them. It is important to maintain a proper balance of moisture in the compost. The compost should be as moist as a well wrung sponge. Once you have aerated your compost simply pour water into the holes until desired moisture is achieved.

WHY COMPOST

- Composting improves the overall health of plants by improving the soil structure. Adding compost to any soil will improve its texture, water retention and fertility.
- Compost is full of microorganisms and soil fauna that help to convert soil nutrients into a form that can be easily absorbed by plants.
- Earthworms and millipedes found in compost tunnel through soil creating pathways around plant roots allowing air and water to enter.
- Composting takes the guess work out of gardening. With so many options today like organic or inorganic fertilizers, knowing when to fertilize your garden and with how much can become confusing and difficult. With compost you can add any amount at any time.
- Soil mixed with compost holds moisture better than regular soil, therefore you can reduce watering.
- Free source of hearty fertilizer!

RETRIEVING YOUR COMPOST

Your compost is ready for use when it is crumbly, dark and gives off a fresh earthy smell. To take the compost out of the bin place your finger in the middle hole and slide the door up (figure 3). Using both hands on the door's handles guide the door onto the knob (figure 4 & 5). For a larger area simply slide the door higher and fit the second hole on the knob (figure 6). Once you are done to close the door, take off of the knob and guide the notch at the bottom into the slit to lock shut.

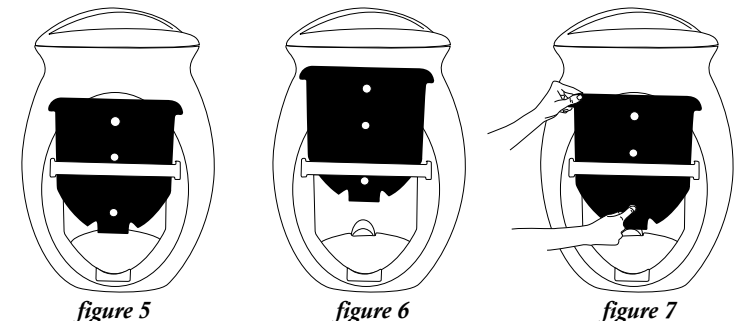
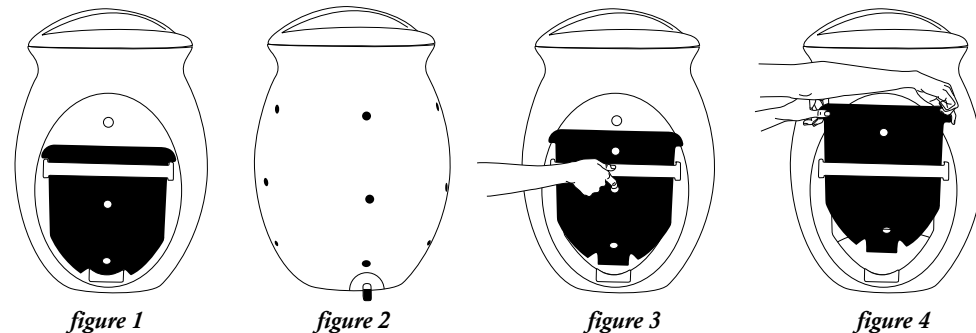



Terra Composter 45 Gallons

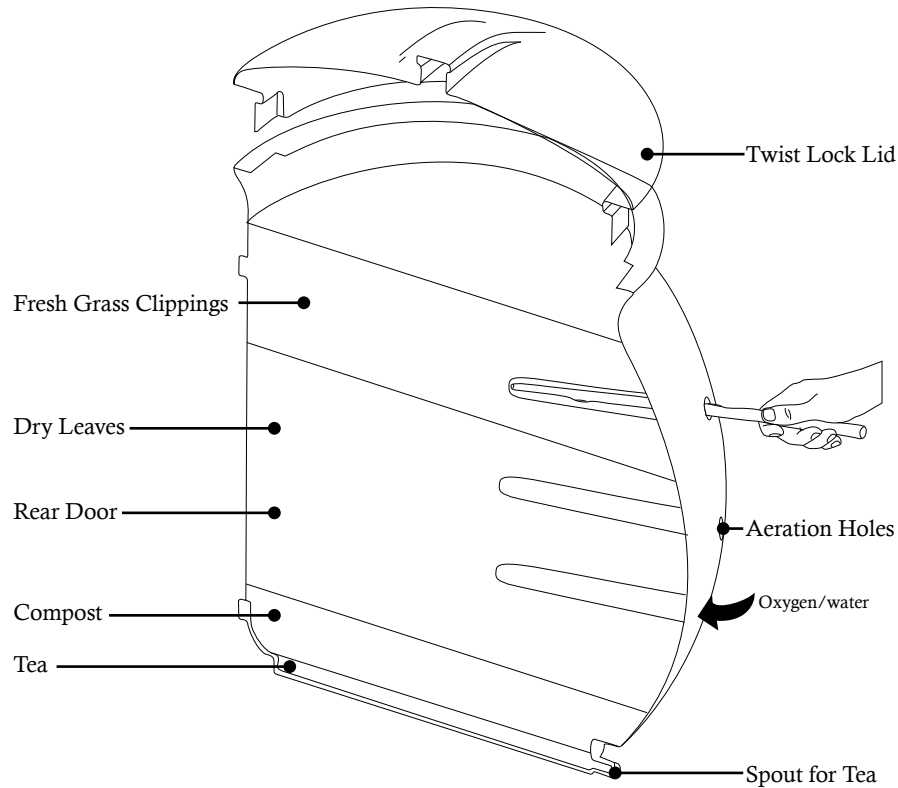

figure 8

WINTER CARE

During the winter months you may leave your composter out, it will keep working though out the winter.

WARRANTY

The Terra Composter carries a 20 Year Limited Warranty on the enclosure only. All accessories included in with the Terra Composter are NOT included in the Warranty. The Warranty covers manufactures defects only. The Warranty does NOT cover neglect or owners misuse.

Proof of purchase must be presented to cover any warranties.



100 Pinebush Road
Cambridge Ontario Canada
N1R 8J8
1-800-984-9933

www.algreenproducts.com

Go Green With Algreen!